

**USE IN CONJUNCTION WITH YOUR MAIN THERMASKIRT® INSTALLATION INSTRUCTIONS**

**IMPORTANT:** Unless the ThermaSkirt® has been supplied factory cut, it is **ESSENTIAL** that the skirting is deburred. 10 revolutions of the ThermaSkirt® de-burrer or similar de-burring tool is recommended. A 'Bell Mouth' chamfer of (approx.) 2mm x 2mm is best to enable ease of installation of connectors. Any swarf or chippings **MUST** be removed before inserting any fittings into the skirting's feed and return channels. Otherwise your **WARRANTY MAY BE INVALID!** (See main installation instructions for full details. To download, go to [www.discreteheat.co.uk/technical.htm](http://www.discreteheat.co.uk/technical.htm)).

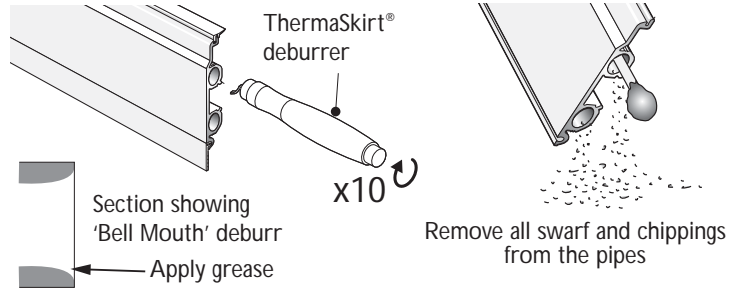

**RETURN MANIFOLD KIT**



Allow 50mm between the ThermaSkirt® and the end of the wall or doorframe for the return manifold.

Before fitting the return manifold, a connector clip **must** be fitted to the skirting. **This must be fitted to the front of the return manifold.** Push the manifold into the ThermaSkirt® (A) making sure it enters straight and not at an angle (see diagram). Ensure that the connector clip engages over the lugs (B).

Finally, before fitting in position, screw the end cover support bracket to the wall, so that it will just touch the return manifold when in position (B).

Engage the skirting with the corner connectors on the previous length of skirting and then push fully home onto the mounting channel.

**USE THE SILICON GREASE PROVIDED!**

Once in position check that the return manifold drain port is in the **OFF** position (C).

Remove the top velcro strip on the end cover support bracket and secure to the back of the cover making sure it will align with the bracket when in position and fit by clipping over the top of the skirting then pushing in the bottom until it clicks into place (D). Push the cover to connect the two velcro strips. Trim the cable cover and caulking gasket 5mm longer than required. These may then be tucked behind the corner covers and end covers to achieve a neat finish (E).

